

# HO EP-5 BODY

PC NO	PART NAME	QTY
1	18-MT048	12
2	25-08-10	1
3	84-01-01	1
4	84-02-01	1
5	84-03-01	1
6	84-04-01	1
7	84-04-02	1
8	84-04-07	2
9	84-05-01	2
10	84-05-02	2
11	84-05-03	2
12	84-05-04	2
13	84-05-05	2
14	84-05-06	2
15	84-05-08	2
16	84-05-09	2
17	84-05-11	2
18	84-05-14	1
19	84-06-01	2
20	84-06-02	2
21	84-06-03	2
22	84-06-04	2
23	84-06-05	2
24	84-06-06	2
25	84-06-07	2
26	84-06-08	2
27	84-06-09	6
28	84-06-10	6

29	84-06-11	4
30	84-06-12	2
31	84-06-13	2
32	84-07-01	6
33	84-07-02	6
34	84-07-03	6
35	84-08-01	1
36	84-08-02	1
37	84-08-03	8
38	84-08-04	2
39	84-08-05	2
40	84-08-06	3
41	84-08-07	2
42	84-08-08	2
43	84-08-09	4
44	84-08-10	2
45	84-09-01	2
46	84-09-02	2
47	84-09-03	1
48	84-09-04	1
49	84-09-05	1
50	84-09-06	1
51	84-09-07	1
52	84-09-08	1
53	84-09-09	2
54	84-09-10	2
55	84-09-11	1
56	84-09-12	1
57	84-09-13	1
58	84-09-14	1

59	84-09-15	1
60	84-09-16	1
61	84-09-17	1
62	84-10-01	2
63	84-10-02	2
64	84-10-03	2
65	84-10-04	2
66	84-10-05	2
67	84-10-06	2
68	84-10-07	4
69	84-10-08	2
70	84-10-09	2
71	84-10-10	8
72	84-11-01	4
73	84-11-02	2
74	84-11-03	2
75	84-11-04	4
76	84-11-05	2
77	84-11-06	2
78	84-11-07	4
79	84-11-08	2
80	84-11-09	1
81	84-11-10	1
82	84-11-11	2
83	84-11-12	2
84	84-11-13	2
85	84-12-02	1
86	84-12-03	1
87	84-12-04	1
88	84-12-05	1

89	84-13-001	2
90	84-13-002	2
91	84-13-003	2
92	84-13-004	4
93	84-MT001	2
94	84-MT002	2
95	84-MT006	2
96	84-MT007	4
97	84-MT008	4
98	84-MT009	4
99	84-MT010	1
100	84-MT012	5
101	84-MT015	4
102	84-MT018	8
103	84-MT019	4
104	84-MT020	2
105	84-MT021	2
106	84-MT022	8
107	84-MT023	4
108	84-MT024	4
109	84-MT025	4
110	84-MT026	2
111	84-MT027	4
112	84-MT028	2
113	84-MT029	2
114	84-MT030	4
115	84-MT031	2
116	84-PCB01	1
117	84-PCB02	2
118	COUPLER	2

119	COUPLER SPRING	1
120	MOTOR(180)	1
121	R1-MT001	2
122	R1-MT002	12
123	R1-MT004	2
124	SCREW 1.4X3 CB	4
125	SCREW 1.4X3 KB	4
126	SCREW 1.4X4 KM	8
127	SCREW 1.4X4 PM	2
128	SCREW 1.7X4 PB	2
129	SCREW 1.7X4 PM	8
130	SCREW 1.7X5 KB	2
131	SCREW 1.7X7 PB	4
132	SOUND PCB	1
133	SPEAKER	2
134	SPRING PIN 5.0	10
135	SQUARE BEARING D2D5H1.5-2	4
136	SWITCH	1
137	WASHER 0.6MM	4
138	WORM D6.0	2

# H0 EP-5 CHASSIS

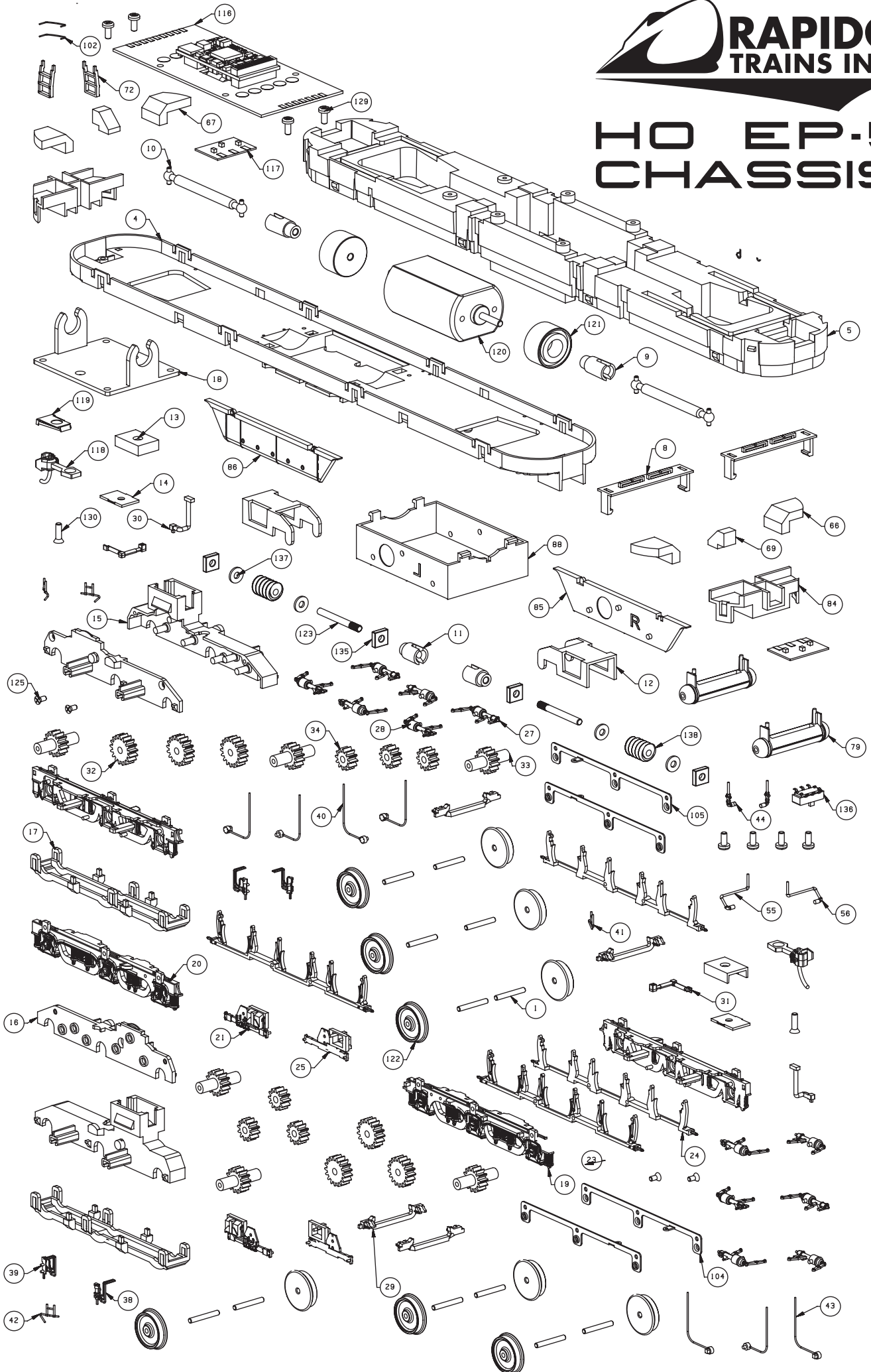

PC NO	PART NAME	QTY
1	18-MT048	12
2	25-08-10	1
3	84-01-01	1
4	84-02-01	1
5	84-03-01	1
6	84-04-01	1
7	84-04-02	1
8	84-04-07	2
9	84-05-01	2
10	84-05-02	2
11	84-05-03	2
12	84-05-04	2
13	84-05-05	2
14	84-05-06	2
15	84-05-08	2
16	84-05-09	2
17	84-05-11	2
18	84-05-14	1
19	84-06-01	2
20	84-06-02	2
21	84-06-03	2
22	84-06-04	2
23	84-06-05	2
24	84-06-06	2
25	84-06-07	2
26	84-06-08	2
27	84-06-09	6
28	84-06-10	6

29	84-06-11	4
30	84-06-12	2
31	84-06-13	2
32	84-07-01	6
33	84-07-02	6
34	84-07-03	6
35	84-08-01	1
36	84-08-02	1
37	84-08-03	8
38	84-08-04	2
39	84-08-05	2
40	84-08-06	3
41	84-08-07	2
42	84-08-08	2
43	84-08-09	4
44	84-08-10	2
45	84-09-01	2
46	84-09-02	2
47	84-09-03	1
48	84-09-04	1
49	84-09-05	1
50	84-09-06	1
51	84-09-07	1
52	84-09-08	1
53	84-09-09	2
54	84-09-10	2
55	84-09-11	1
56	84-09-12	1
57	84-09-13	1
58	84-09-14	1

59	84-09-15	1
60	84-09-16	1
61	84-09-17	1
62	84-10-01	2
63	84-10-02	2
64	84-10-03	2
65	84-10-04	2
66	84-10-05	2
67	84-10-06	2
68	84-10-07	4
69	84-10-08	2
70	84-10-09	2
71	84-10-10	8
72	84-11-01	4
73	84-11-02	2
74	84-11-03	2
75	84-11-04	4
76	84-11-05	2
77	84-11-06	2
78	84-11-07	4
79	84-11-08	2
80	84-11-09	1
81	84-11-10	1
82	84-11-11	2
83	84-11-12	2
84	84-11-13	2
85	84-12-02	1
86	84-12-03	1
87	84-12-04	1
88	84-12-05	1

89	84-13-001	2
90	84-13-002	2
91	84-13-003	2
92	84-13-004	4
93	84-MT001	2
94	84-MT002	2
95	84-MT006	2
96	84-MT007	4
97	84-MT008	4
98	84-MT009	4
99	84-MT010	1
100	84-MT012	5
101	84-MT015	4
102	84-MT018	8
103	84-MT019	4
104	84-MT020	2
105	84-MT021	2
106	84-MT022	8
107	84-MT023	4
108	84-MT024	4
109	84-MT025	4
110	84-MT026	2
111	84-MT027	4
112	84-MT028	2
113	84-MT029	2
114	84-MT030	4
115	84-MT031	2
116	84-PCB01	1
117	84-PCB02	2
118	COUPLER	2

119	COUPLER SPRING	1
120	MOTOR(180)	1
121	R1-MT001	2
122	R1-MT002	12
123	R1-MT004	2
124	SCREW 1.4X3 CB	4
125	SCREW 1.4X3 KB	4
126	SCREW 1.4X4 KM	8
127	SCREW 1.4X4 PM	2
128	SCREW 1.7X4 PB	2
129	SCREW 1.7X4 PM	8
130	SCREW 1.7X5 KB	2
131	SCREW 1.7X7 PB	4
132	SOUND PCB	1
133	SPEAKER	2
134	SPRING PIN 5.0	10
135	SQUARE BEARING D2D5H1.5-2	4
136	SWITCH	1
137	WASHER 0.6MM	4
138	WORM D6.0	2